

# Little House - Ground Floor Plan

Single storey - 3 bed

Total area - 151m<sup>2</sup>

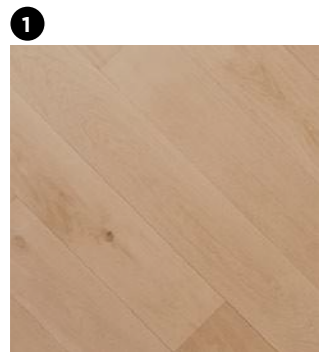
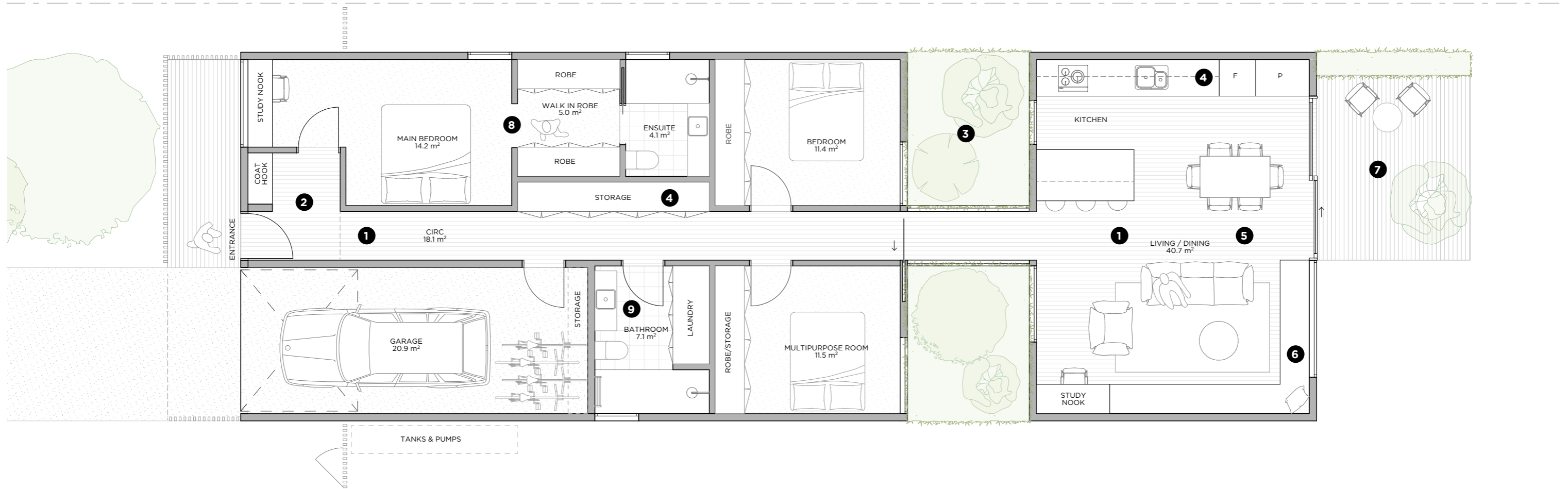

1 Engineered timber flooring

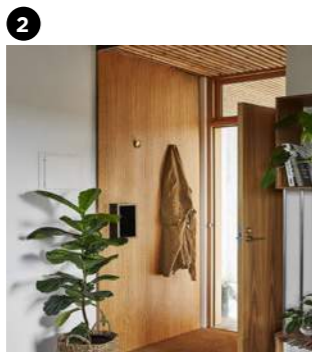

2 Timber lined entrance

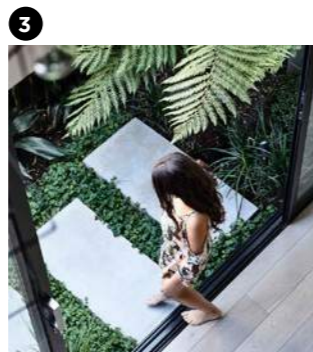

3 Lush green lightcourts

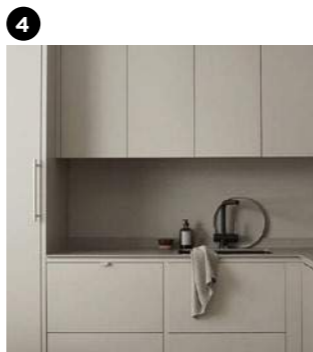

4 Solid colour laminate joinery

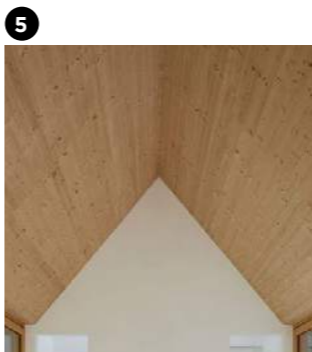

5 Timber lined ceiling in living & kitchen



6 Window seats in living room

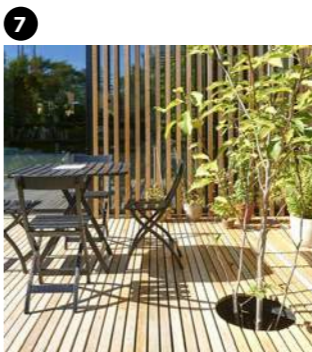

7 Outdoor decking with tree cut-out



8 Carpet to bedrooms



9 Timber joinery to bathrooms



**Little House  
Homestead**

Option 1

# Entry Sequence - Option 1



1 Timber facade

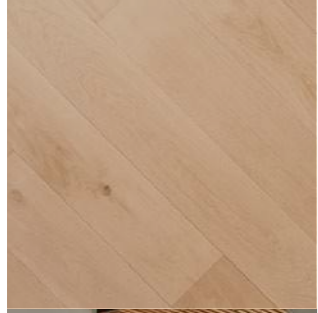

2 Timber flooring



3 Timber entrance door



4 Timber ceiling to entrance



5 Grooved board to coat nook

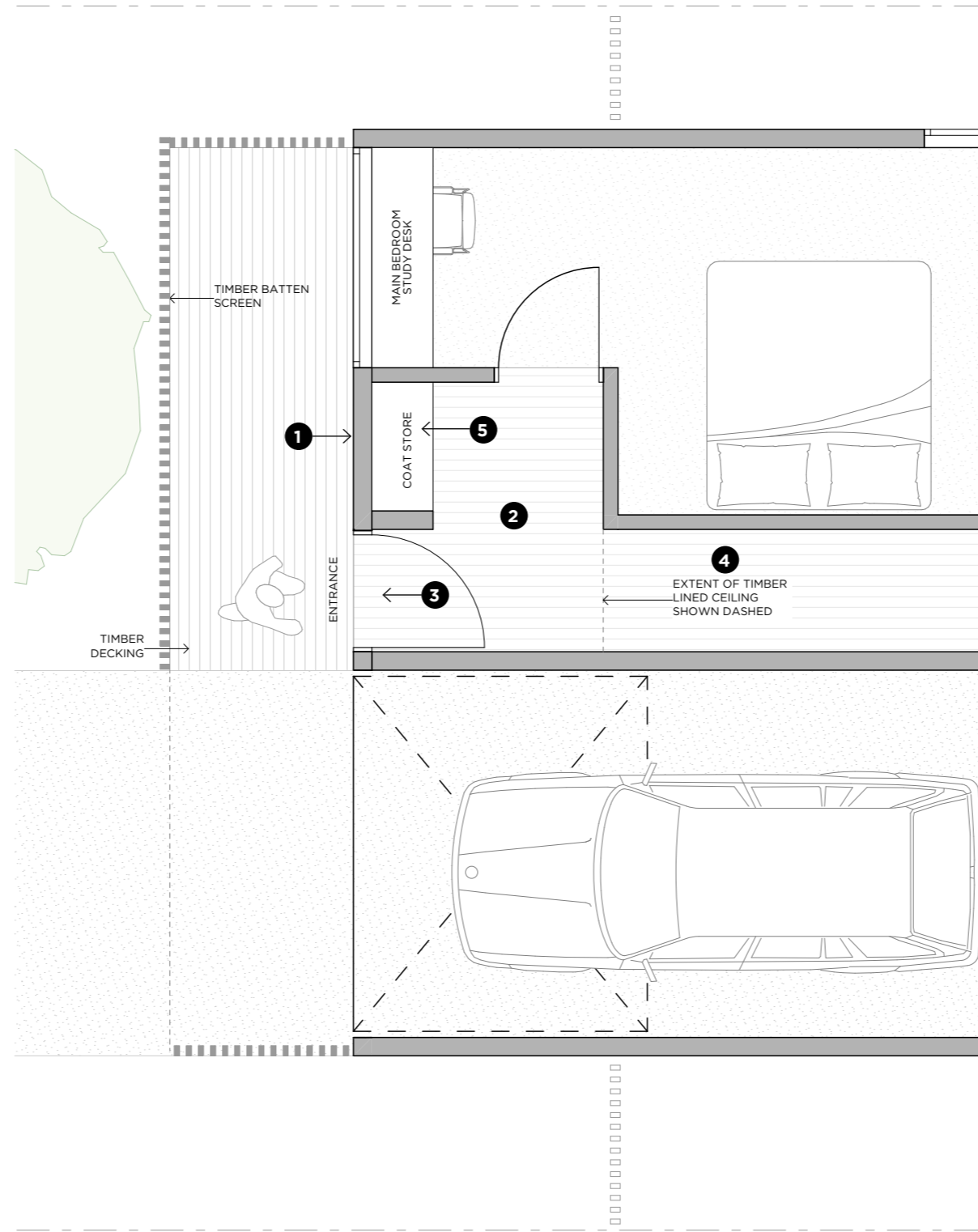



**Little House  
Homestead**

Option 2

# Entry Sequence - Option 2



1 Timber facade

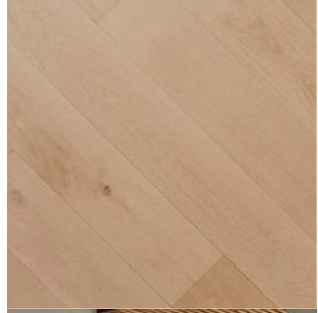

2 Timber flooring



3 Timber entrance door



4 Timber ceiling to entrance



5 Grooved board to coat nook

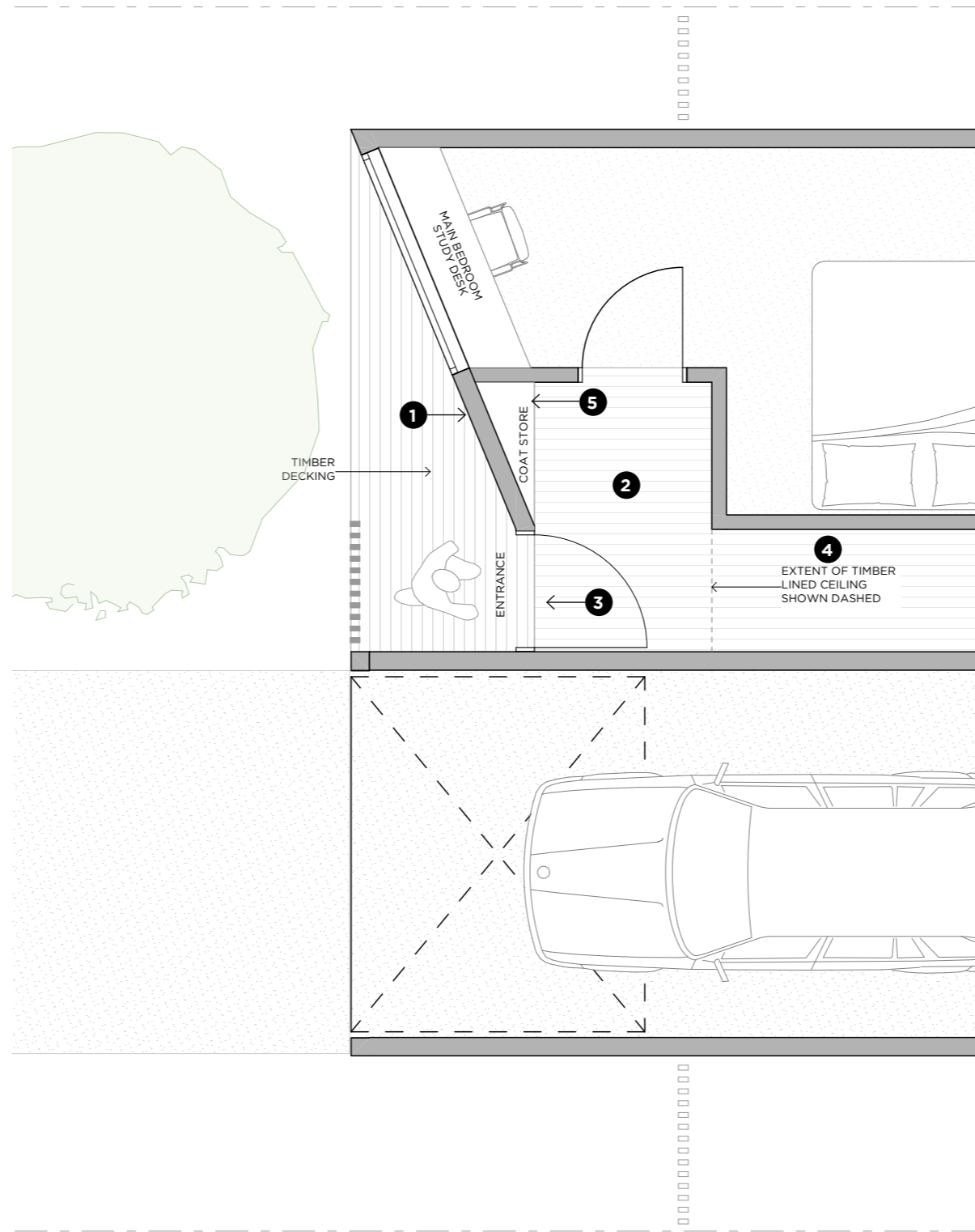



**Little House  
Homestead**

Option 3

# Entry Sequence - Option 3



1 Timber facade

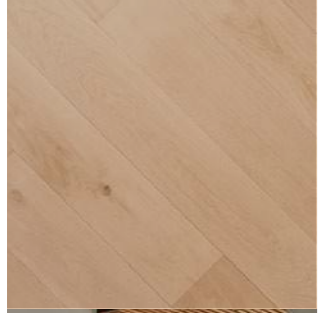

2 Timber flooring



3 Timber entrance door



4 Timber ceiling to entrance



5 Grooved board to coat nook

