

# Big House - Ground Floor Plan

Double storey - 4 bed

Total area - 214m<sup>2</sup>

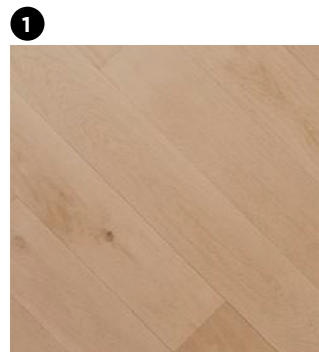

1 Engineered timber flooring

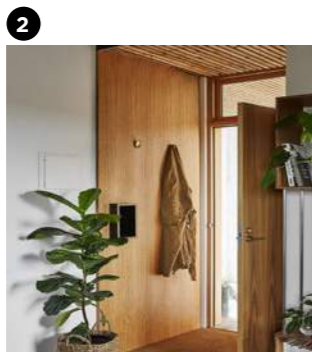

2 Timber lined entrance

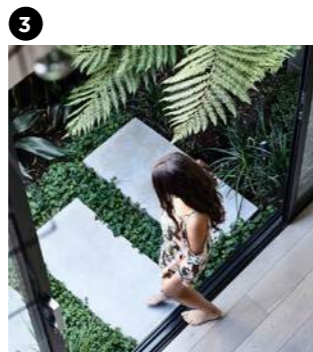

3 Lush green lightcourts

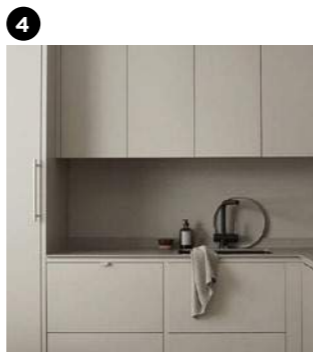

4 Solid colour laminate joinery

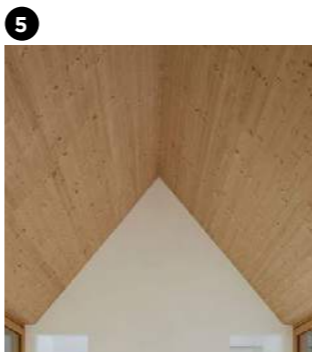

5 Timber lined ceiling in living & kitchen



6 Window seats in living room

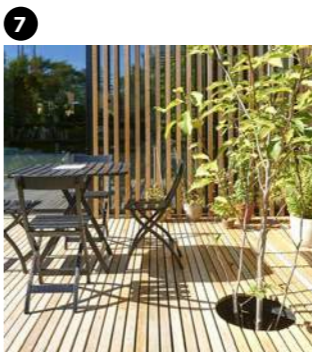

7 Outdoor decking with tree cut-out



8 Carpet to bedrooms



9 Timber joinery to bathrooms

# Big House - First Floor Plan

Double storey - 4 bed

Total area - 214m<sup>2</sup>

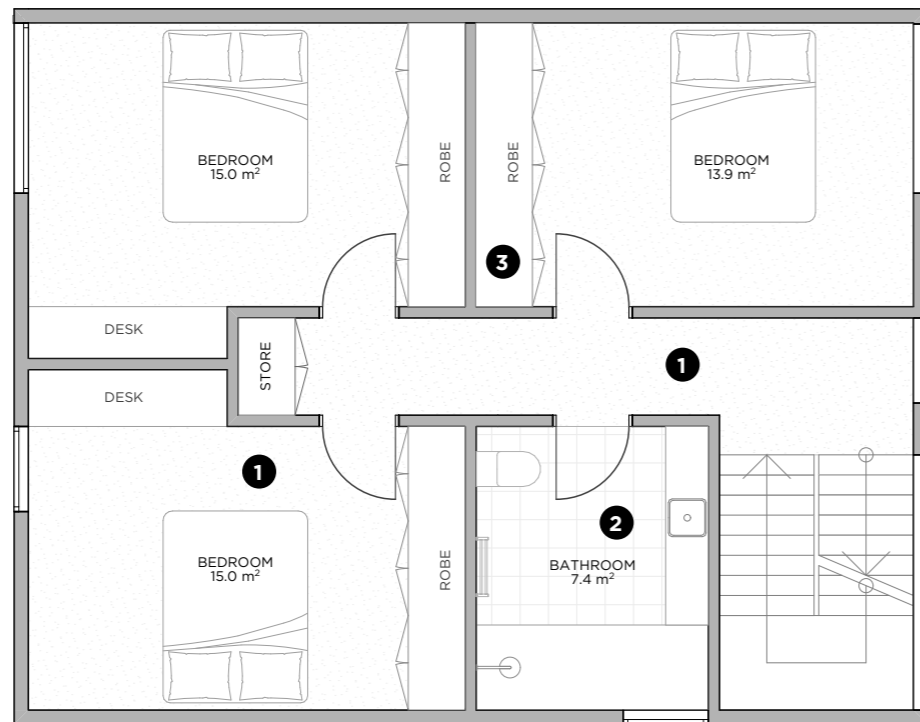

1 Carpet to bedrooms

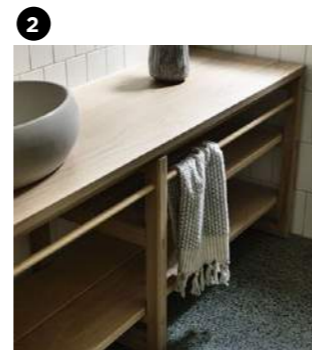

2 Timber joinery to bathrooms

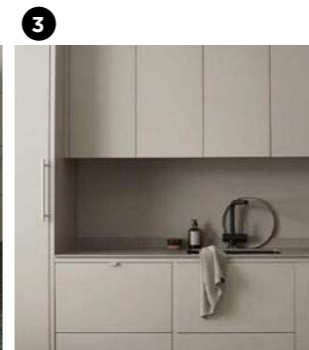

3 Solid colour laminate joinery



**Up and Down  
Big House**

**Option 1**

# Entry Sequence - Option 1



1 Timber facade

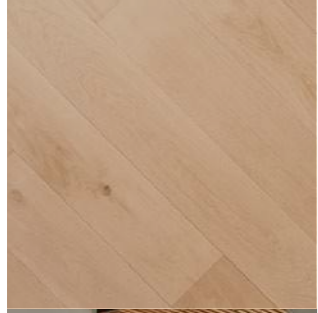

2 Timber flooring



3 Timber entrance door



4 Timber ceiling to entrance



5 Grooved board to coat nook

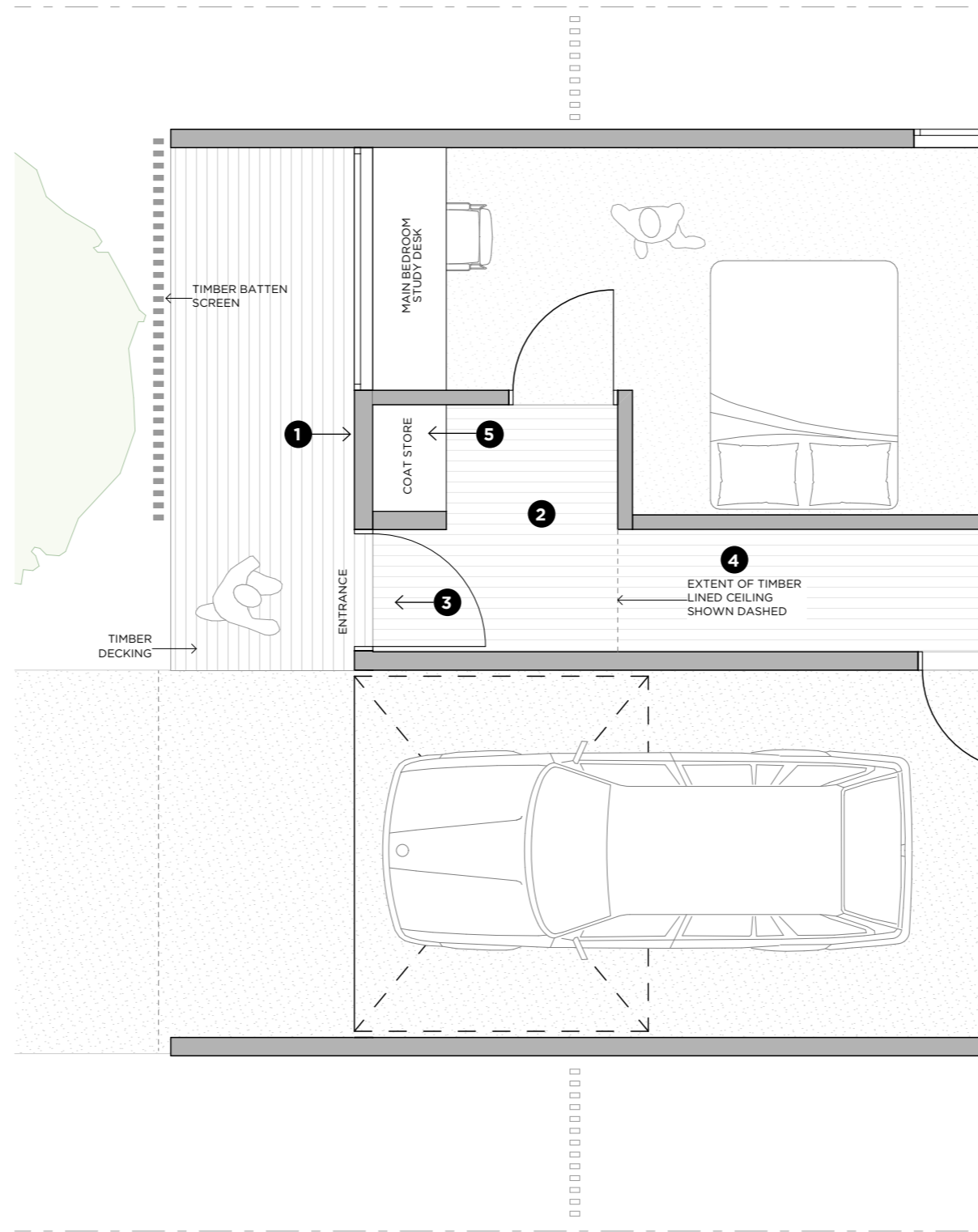



**Up and Down  
Big House**

**Option 2**

# Entry Sequence - Option 2



1 Timber facade

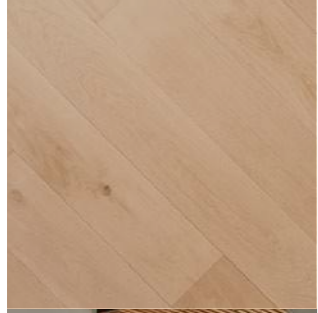

2 Timber flooring



3 Timber entrance door



4 Timber ceiling to entrance



5 Grooved board to coat nook

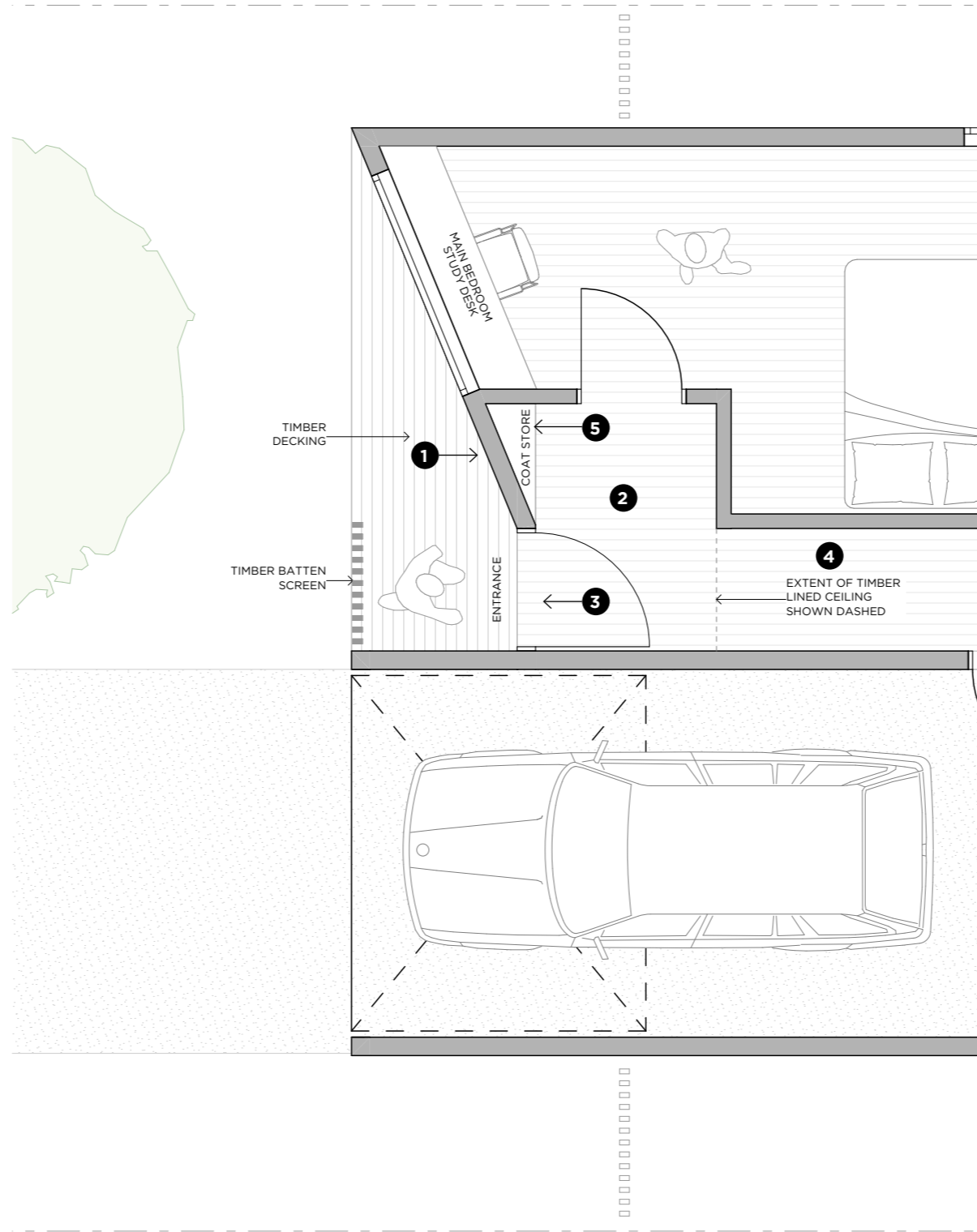



**Up and Down  
Big House**

**Option 3**

# Entry Sequence - Option 3



1 Timber facade

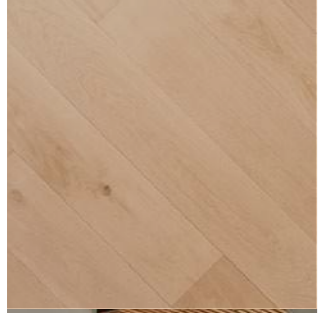

2 Timber flooring



3 Timber entrance door



4 Timber ceiling to entrance



5 Grooved board to coat nook

